



SPECIFICATIONS

External single control

Red canyon PVD

Anti limescale aerator M 24 x 1

Auto return deviator

ø 1/2" outlet

50% two step cartridge for water saving

Packaging: 37,1 x 23,7 x 11 cm / 0,009671 m³

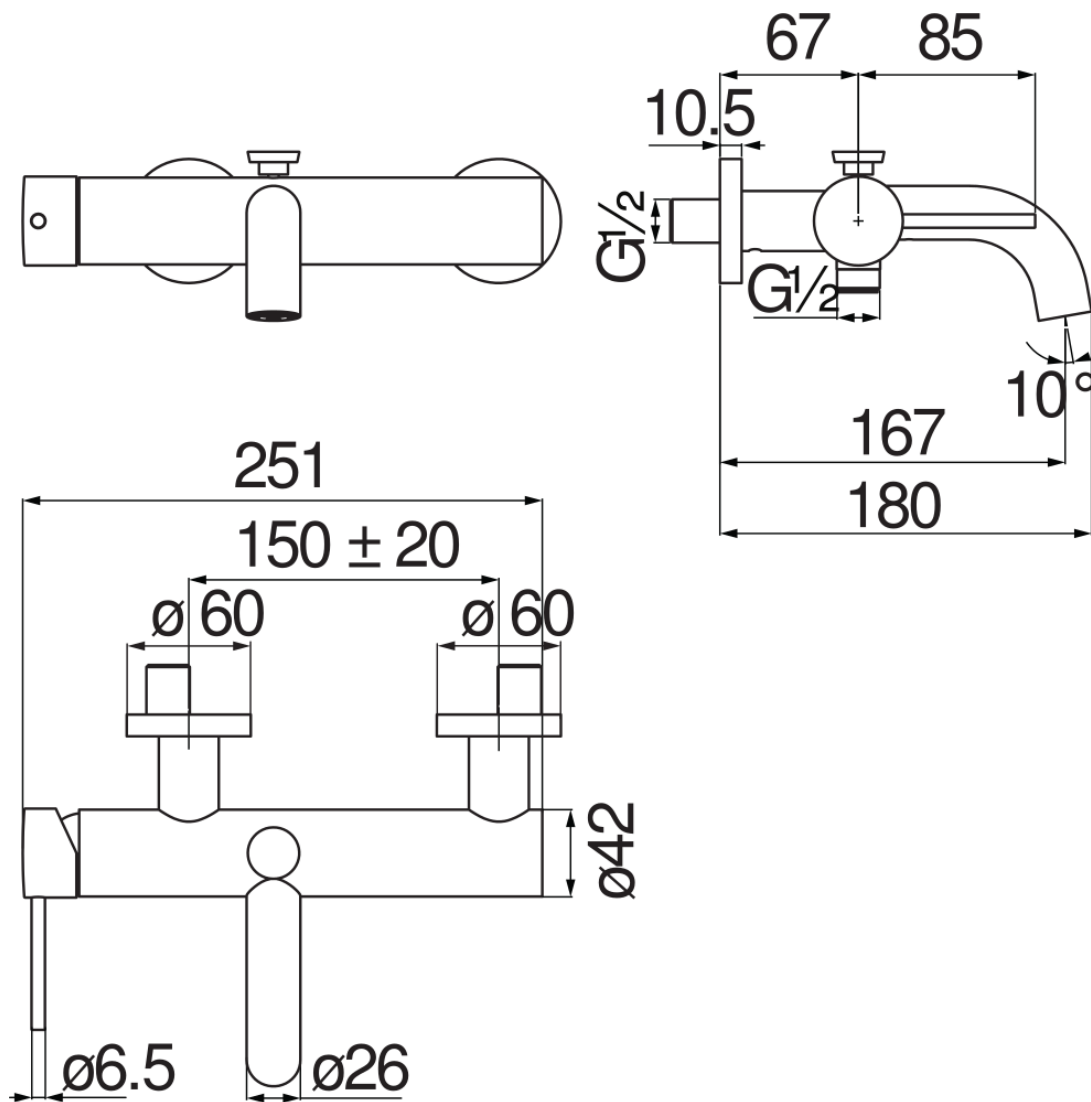

FLOW RATE DIAGRAM: HOT/COLD WATER

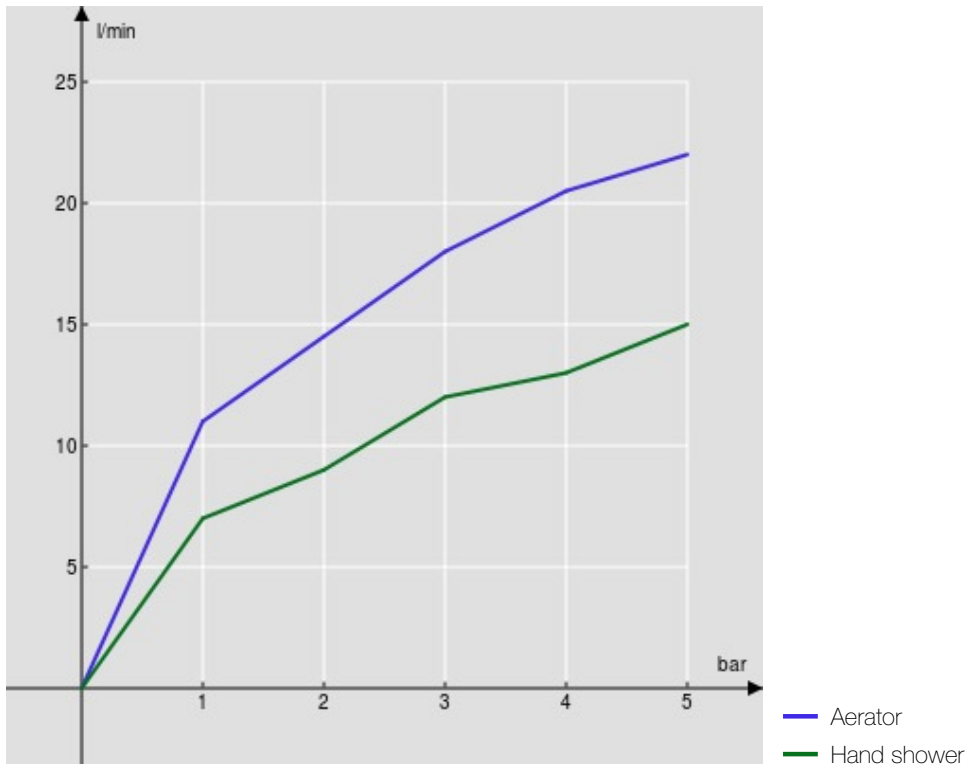

FLOW RATE DIAGRAM: MIXED WATER

