

Not included / Non incluso / Non Inclus / Nie zawarty/ No incluido / Nao incluido

1

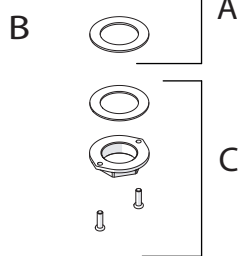

2

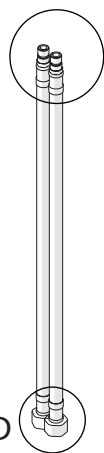
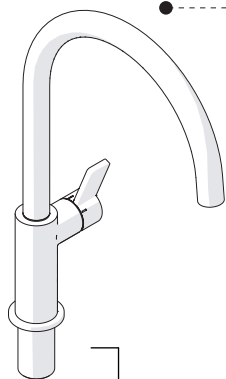
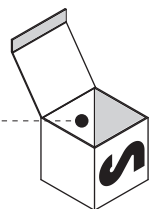
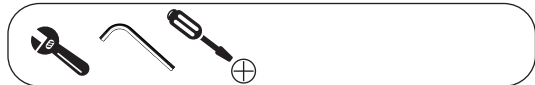
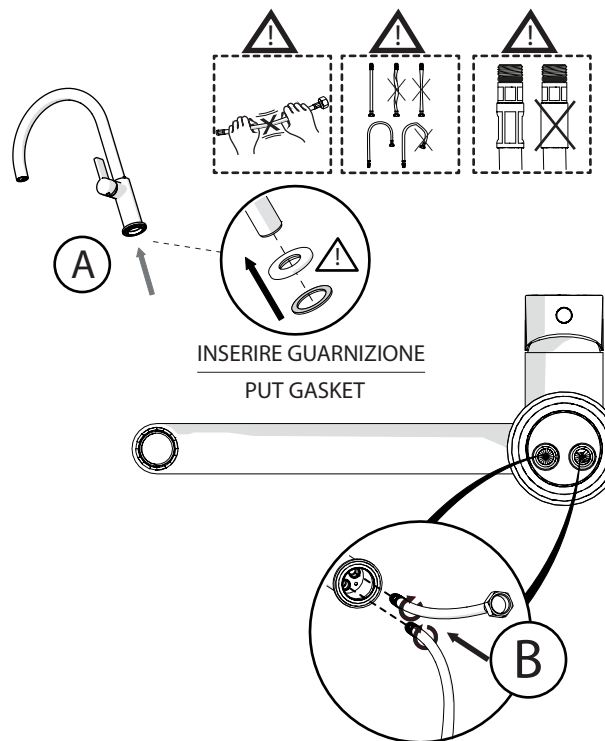

3

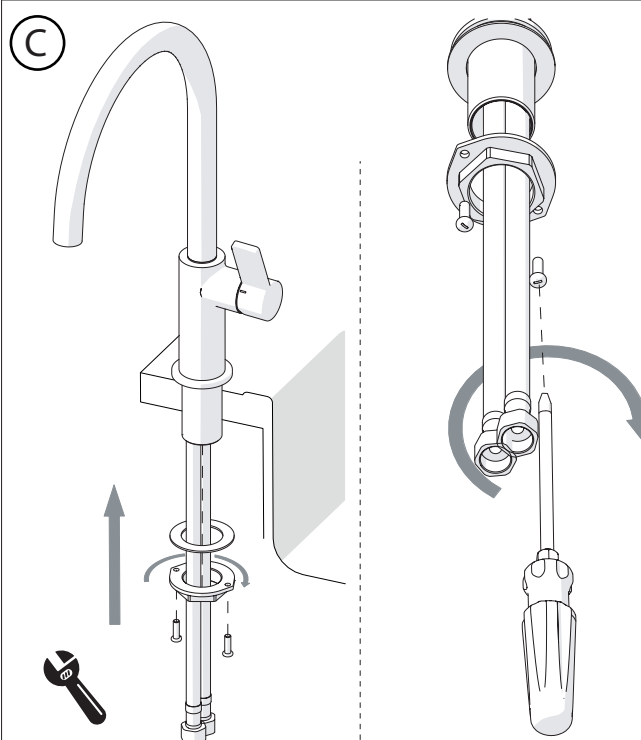

4

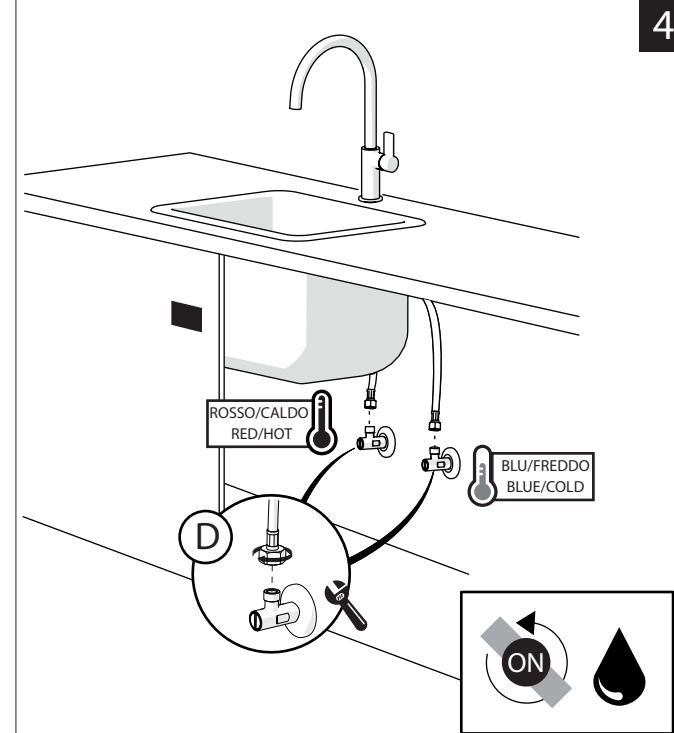

5

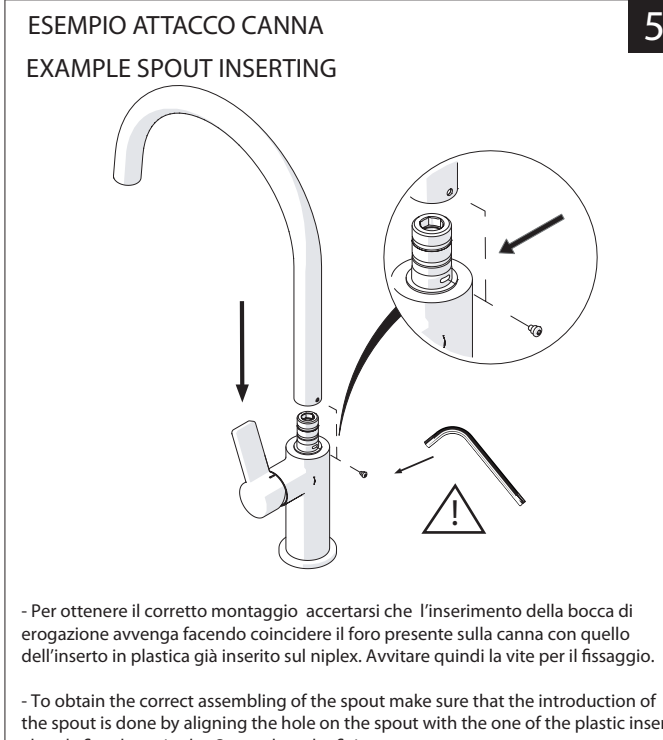

**-50%**

Dispositivo limitatore "dinamico"  
della portata d'acqua "50%"  
"Dynamic" flow rate restrictor "50%"



**ECO**

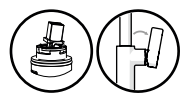

ON 50%

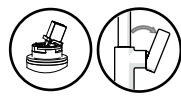

ON 100%

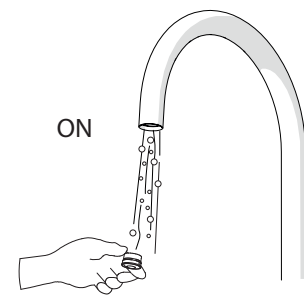
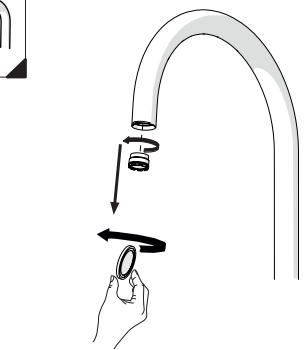

DISEGNO TECNICO  
TECHNICAL DRAWING

**6**

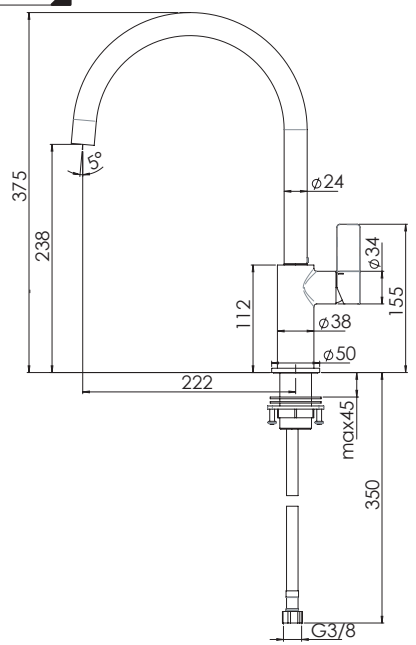

**7**



Per limitare la temperatura estrarre il limitatore  
e riposizionarlo nella posizione che si desidera

**8**

Extract the limiter and put it in correct  
position to limit temperature

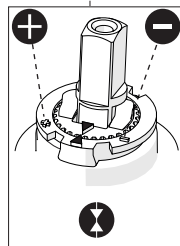
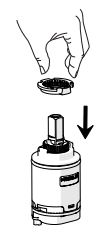
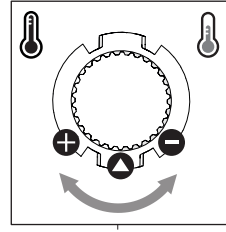
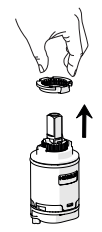

Nessuna limitazione  
di temperatura  
No limitation  
of temperature

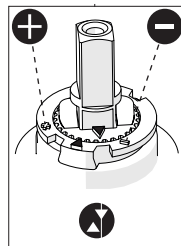

Limitazione parziale  
di temperatura  
Partial limitation  
of temperature

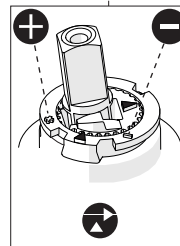

Massima limitazione  
Solo acqua fredda  
Maximum position  
Only cold water

**NOBILI**

FL96113/X

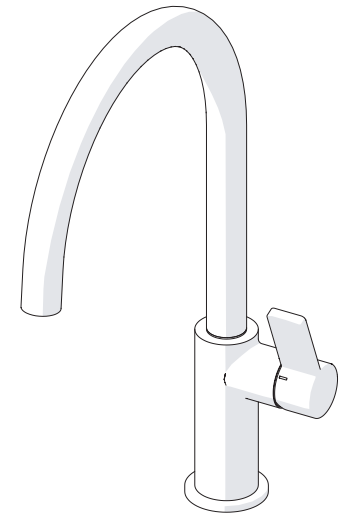

www.nobili.it

ⓘ Per quanto previsto dal decreto legge n. 135/2009 del 25 Settembre 2009, convertito in legge 166/2009 si dichiara che alcuni componenti di questo prodotto sono di importazione extra UE.  
Ⓞ Bylaw n. 135/2009 dd.25th September 2009 - As bylaw enacted, convert in law 166/2009 we state that some components of this product are imported from extra-Eu countries.

PRIMA DI INIZIARE / BEFORE STARTING

	P bar		MAX 10 MIN		5		T	T °C		MAX 80		65 45
--	----------	--	------------------	--	---	--	---	---------	--	-----------	--	----------

PULIZIA / CLEANING

ACQUA WATER	ALCOOL	MICROFIBRA MICROFIBER	SPUGNA SPONGE	DETERGENTI DETERGENT

--	--	--	--

IISTRFL96113/X#---STD



REV0.01/2020